

Econoboard Coated Insulation

For installation beneath underfloor heating on a timber substrate

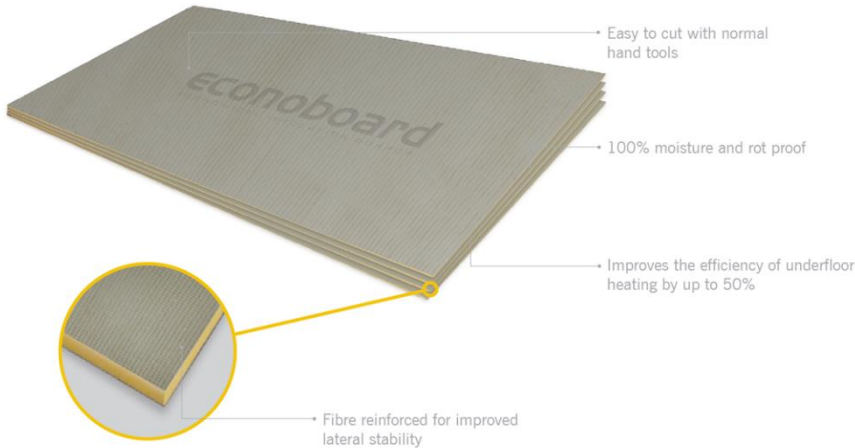

Board Size	1.2 x 0.6
Board Area	0.72m ²
Thermal Conductivity	0.033W/MK
Compressive Strength	300 kpa
Water Absorption	0.6% by vol
Temperature Range	-50°C to +75°C

Installation Overview

Using Econoboard Coated and the range of fixing accessories quickly creates an ideal, stable substrate for tile adhesive and underfloor heating. It can be used on floors and walls and is 100% rot proof which makes it ideal for use in bathrooms and wetrooms.

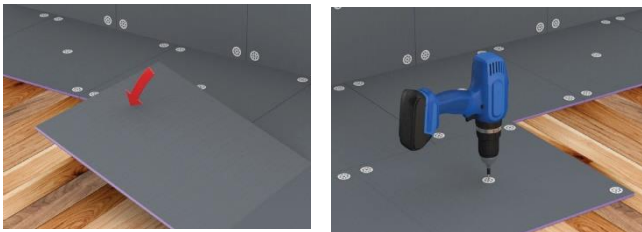

1. Ensure the timber substrate is secure and free from dust and any debris.
2. Cut boards to size with a sharp blade and position over the floor area in an offset brick pattern.
3. Fix in position using fixing screws (6020) and washers (6016) at 300mm centres (10 washers per board).

Stock Code	Thickness (mm)	Pack Quantity	Pack Area (m ²)	R Value m ² k/w
6106	6	8	5.76	0.15
6110	10	6	4.32	0.27

Accessories

Stock Code	Description	Unit
6015	100mm Reinforcing Tape 25m roll*	Ea
6016	Zinc Fixing Washers (35mm)	pk 100
6022	Fixing Washers (32mm) and Screws	pk 100

*Allow 2m of Tape per board

