



# Therмотouch 5235W

Wi-Fi Enabled Thermostat

Simplified Instruction Version

**therмотouch**  
INTELLIGENT HEATING CONTROLS

Thank you for buying our Thermotouch 5235W thermostat. We hope you will enjoy the ease of use offered by the touchscreen and intuitively designed interface. You can program the thermostat any way you want with the options provided under Heating Schedule and User Settings.

The thermostat will switch on your heating system at predetermined times each day of the week. You can set individual temperatures for up to six separate periods, called events, for each day of the week. Lowering the temperature when your home is unoccupied will reduce your energy costs without reducing comfort.

The thermostat comes with a preset heating schedule suitable for most homes. Unless you change the settings, the thermostat will operate according to this preset heating schedule.

The thermostat features an adaptive function that automatically changes heating start times to ensure that the required temperature has been reached at the beginning of any specific event. After a few days, the adaptive function will have learned how much earlier the heating must be switched on.

The resistive touchscreen only requires a soft tap with your fingertip to register the touch.

In this manual, the touch areas on the screen will be referred to as buttons.

The Wi-Fi version of the this Thermotouch offers remote control of your underfloor heating through the SWATT® (Smart Wi-Fi and Touch Thermostat) app, which can be downloaded from both Google Play and App store.

This installation guide and manual is designed to provide all the details required to install and setup your 5235W Thermotouch thermostat. There is a full detailed User Guide which includes additional settings and troubleshooting should these be required. This is available at [www.thermogroup.com.au/5235W\\_Guide](http://www.thermogroup.com.au/5235W_Guide) or by scanning the QR code below.

The detailed guide includes everything in this guide as well as:

- General Operation
- Icons
- Display Brightness
- Screen Saver
- Energy Tariff
- Eco Function
- Date Format
- Time Format
- Daylight Saving Time
- Unit
- Language
- Open Window
- Sensor Type
- Floor Sensor Calibration
- Room sensor calibration
- Temperature Scale
- EN50559
- Remove from App
- Factory Settings
- Detailed Troubleshooting

Scan here to view the detailed guide.



<b>Introduction</b>	<b>02</b>	<b>Adaptive Function</b>	<b>24</b>
<b>Before you start</b>	<b>05</b>	<b>Heating Schedule</b>	<b>25</b>
<b>Installing your thermostat</b>	<b>06</b>	<b>Child Lock</b>	<b>28</b>
<b>Wiring Diagram</b>	<b>09</b>	<b>Date</b>	<b>29</b>
<b>Startup Wizard</b>	<b>12</b>	<b>Time</b>	<b>30</b>
<b>Operating Modes</b>	<b>14</b>	<b>Sensor Application</b>	<b>31</b>
<b>Scheduled Operation</b>	<b>15</b>	<b>Factory Reset</b>	<b>32</b>
<b>Manual</b>	<b>16</b>	<b>Wi-Fi Connection</b>	<b>33</b>
<b>Comfort</b>	<b>17</b>	<b>Connect to app</b>	<b>37</b>
<b>Boost</b>	<b>19</b>	<b>Using the app</b>	<b>39</b>
<b>Frost Protection</b>	<b>20</b>	<b>Troubleshooting</b>	<b>46</b>
<b>Holiday</b>	<b>21</b>	<b>Technical Information</b>	<b>47</b>
<b>Eco Function</b>	<b>23</b>		

## Check you have got everything:

- 5235W Thermostat
- Mounting Plate
- Fixing Bracket
- 3M Sensor Probe
- 2M Sensor Conduit
- Fixing Screws
- Electrical Screwdriver
- Wire Strippers
- Electrical Test Meter

## Your thermostat should be:

- Installed 1.2 - 1.5m up from the floor
- On an internal wall
- Outside any wet zones (IP21)
- Installed on an RCD protected circuit
- Away from drafts or heat influencers
- Installed so that the floor sensor probe can be laid in a heated area of the floor
- Installed by an electrician, in line with current electrical regulations and relevant local standards

# 1. Switch off main power

You will be installing your thermostat as part of a high voltage mains electrical circuit. To ensure your safety and to protect the thermostat, switch off the mains power before you start the installation.

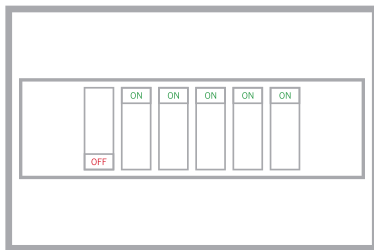

Fuse Box

## 2. Installation Location

At this stage it is likely that an RCD protected electric underfloor heating system has been installed and a standard electrical plate is already in place.

The underfloor heating cold tail should be pulled up through the back plate, and the sensor probe installed (in the conduit provided) within the wall cavity or pre chased channel in a solid wall.

### 3. Maximum Distance

Your thermostat can be installed up to 50m away from the underfloor heating system it is controlling, provided that the floor sensor is used to control the temperature.

Underfloor heating cold tails and floor sensor probes can be extended up to 50m.



Connect multiple heaters in parallel.



## 4. Wiring Diagram

Connect the thermostat to the Underfloor Heating cold tail, power supply and floor temperature sensor.

The floor temperature sensor is not polarity sensitive.

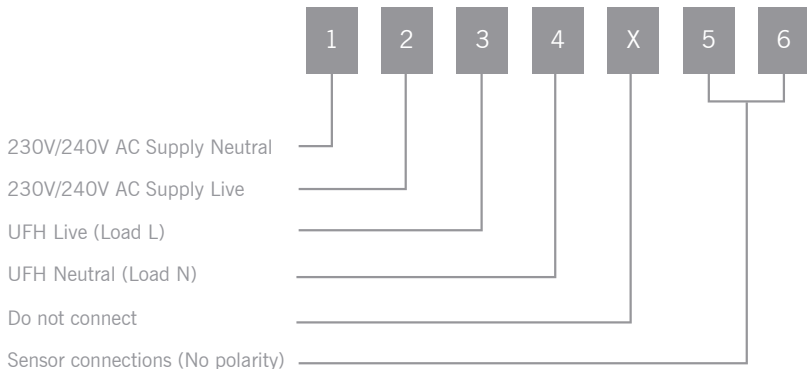

## 5. Fix Mounting Plate

Fix your thermostat in position onto the electrical plate in either the vertical or horizontal position.

Ensure the unit is switched off using the switch on the side of the unit, to allow for the screen to be clipped into position.

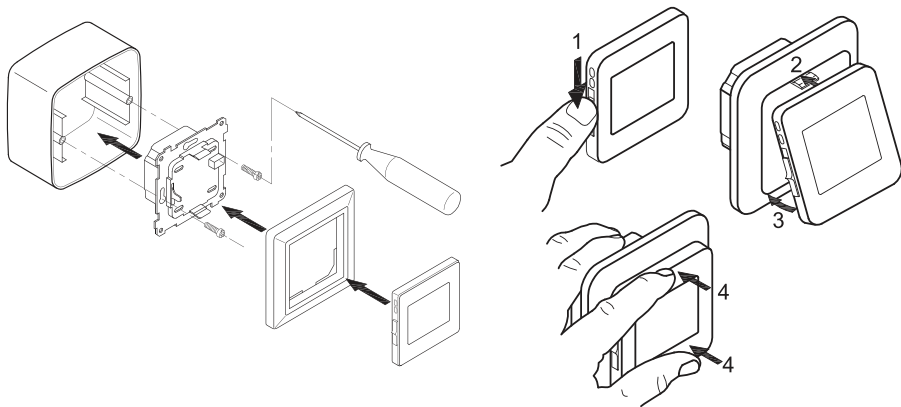

### 6. Switching on your system

It is important that all adhesives and grouts are dry and fully cured before you switch on your underfloor heating.

Most adhesives take between 7 to 10 days to cure. Follow manufacturer guidelines.

The temperature of your underfloor heating should be increased gradually to avoid thermal shock in the floor. Start at 15°C and work up to your desired temperature increasing 2-3°C per day.

Observe any maximum temperature guidelines from your floor manufacturer.

Australian regulation states the heating cannot exceed 28°C.



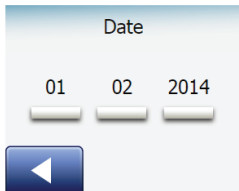
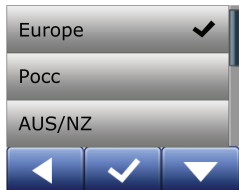

When the system has been installed and turned on for the first time, or after you have performed a factory reset, you must set the region, Language, Date, Time and Floor Type. Refer to pages 42 - 48. The thermostat will automatically guide you through the process.

1. Region – set the time region in which the thermostat is located.  
Tap the time region you are in.  
Confirm with “✓”
2. Language – set the language to be used on the thermostat display.  
Tap the language you prefer. Confirm with “✓”.
3. Date – set the current date.  
Tap the parameter you want to change.  
The selected parameter will enlarge and be underlined in black.  
Use the “Up Arrow” or “Down Arrow” button to set the day, month and year.  
Confirm the date with the “Right Arrow”.

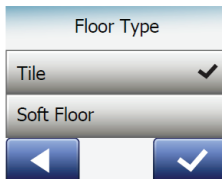
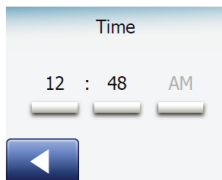

4. Time – set the current time.  
Tap the parameter you want to change.  
The selected parameter will enlarge and be underlined in black.  
Use the “Up Arrow” or “Down Arrow” button to set the hours and minutes.  
Confirm the date with the “Right Arrow”.
5. Floor Type – choose between:  
Tile: floors made of tile or stone.  
Soft Floor: wooden or other engineered floors.  
Confirm each setting with “✓”.

The thermostat is now ready for use and will control the underfloor heating according to the preset heating schedule. If you want to change the heating schedule, instructions are given in the section titled Heating Schedule.

Details of the preset heating schedule are given in the section titled Factory Settings.

The thermostat offers seven different modes of temperature control, either from the “Other” menu on the home screen or from the home screen directly:

1. Scheduled Operation
2. Frost Protect
3. Manual
4. Holiday
5. Comfort
6. Eco (this function must be enabled in the “User Settings” menu)
7. Boost

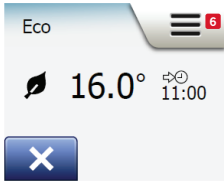
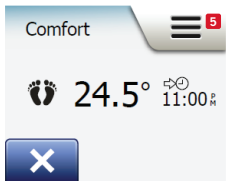
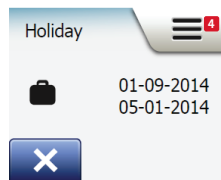
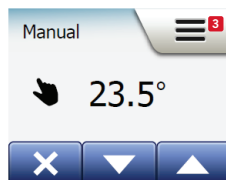
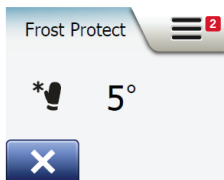



The system will operate in Scheduled Operation unless you choose to override the scheduled events.

During Scheduled Operation, the temperature is controlled automatically according to the programmed heating schedule – see “Heating Schedule”.

During Scheduled Operation, “Manual” and “Other” modes are accessible from the home screen. If the Eco function is enabled, “Eco” and “Other” modes will be accessible from the home screen. “Manual” will then be found in the “Other” menu.

The function of the buttons and symbols shown on the home screen varies according to the chosen operating mode.

Scheduled Operation home screen:

1. Day and time info.
2. Tap here to access the menus.
3. Icon indicating the current operating mode (Calendar = Scheduled Operation).
4. Current target/setpoint temperature (if shown in red, heating is being provided).
5. Time of next scheduled event change.
6. If shown, the adaptive function is enabled.
7. Tap here to access Manual Override. Alternatively, if Eco Function is enabled, tapping here activates the eco function.
8. Tap here to access alternative operating modes (Comfort, Boost, Frost Protect, Holiday). If “Eco” is enabled, “Manual” will be found here as well.



Manual allows you to override Scheduled Operation and maintain a specified temperature around the clock.

1. From the Scheduled Operation home screen, tap the “Manual” button to access manual override.

Note: If Eco is enabled, “Manual” will be found in the “Other” menu. You can use “Manual” to override the programmed event schedule. The thermostat will continue to operate in Manual until you return it to Scheduled Operation.

2. Use the “Up Arrow” or “Down Arrow” button to select the required temperature. Then simply leave the thermostat as it is.

While in Manual Override, an “X” button is shown in the lower left corner of the home screen. Press this button to return the thermostat to Scheduled Operation. The function of the buttons and symbols shown on the home screen varies according to the chosen operating mode.

Manual home screen:

1. Indication of Manual Override.
2. Tap here to access the menus.
3. Icon indicating the current operating mode (Hand = Manual).
4. Current target/setpoint temperature  
(if shown in red, heating is being provided).
5. Tap here to return to Scheduled Operation.
6. Tap here to decrease the target/setpoint temperature.
7. Tap here to increase the target/setpoint temperature.



You can use Comfort mode on special occasions when you want to override an event during Scheduled operation, e.g. for a party or when you want to stay up late. You can manually set a comfort temperature, which the thermostat will maintain for a chosen period of time (from 1 to 23 hours) before returning to Scheduled Operation.

1. From the Scheduled Operation home screen, tap the “Other” button to access the alternative operating modes.
2. Choose “Comfort”.
3. Tap “✓” to confirm that you wish to override the programmed heating schedule.
4. Use the “Up Arrow” or “Down Arrow” button to select the required temperature. Confirm with “✓”.
5. Use the “Up Arrow” or “Down Arrow” button to set the required duration of Comfort mode. Confirm with “✓”.

The thermostat automatically enters the Comfort mode home screen.

While in comfort mode an “X” button is shown on the home screen. Press this button to return the thermostat to Scheduled Operation.



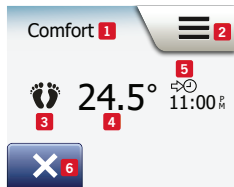

Comfort home screen:

1. Indication of Comfort mode.
2. Tap here to access the menus.
3. Icon indicating the current operating mode (Feet = Comfort).
4. Current target/setpoint temperature  
(if shown in red, heating is being provided).
5. The time at which the thermostat will return to Scheduled Operation.
6. Tap here to quit Comfort mode and return to Scheduled Operation.

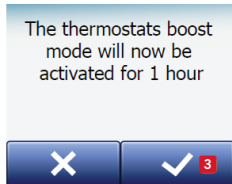
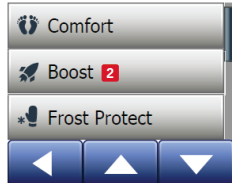
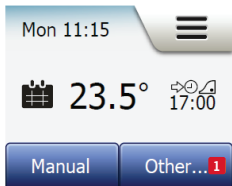

Boost mode is accessible from the “Other” menu.

In Boost mode, the underfloor heating is constantly activated for one hour. After one hour, the thermostat returns to Scheduled Operation.

1. From the Scheduled Operation home screen, tap the “Other” button to access the alternative operating modes.
2. Choose “Boost”.
3. Confirm that you wish the thermostat to activate Boost mode by tapping “✓”. The thermostat automatically enters the Boost home screen.

While in Boost mode, an “X” button is shown on the home screen. Press this button to return the thermostat to Scheduled Operation.



Boost home screen:

4. Indication of Boost mode.
5. Tap here to access the menus.
6. Icon indicating the current operating mode (Red Rocket = Boost).
7. The time at which the thermostat will return to Scheduled Operation.
8. Tap here to quit Boost mode and return to Scheduled Operation.

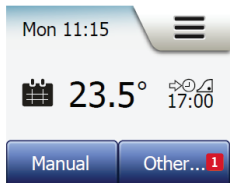

Frost Protection mode is used when heating is not needed but the temperature must be kept above freezing point until changed manually.

1. Tap the “Other” button on the home screen.
2. Tap the “Frost Protect” button.

A confirmation screen will then be displayed briefly before the thermostat automatically enters the Frost Protect home screen.

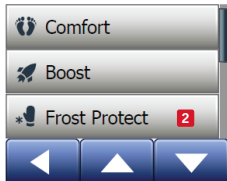

While in Frost Protection mode an ice crystal and glove are displayed on the home screen together with the target/setpoint temperature (5.0°C).

Frost Protection home screen:

3. Indication of Frost Protection mode.
4. Tap here to access the menus.
5. Icon indicating the current operating mode (Ice Crystal and Glove = Frost Protection).
6. Fixed target/setpoint temperature (if shown in red, heating is being provided).
7. Tap here to return to Scheduled Operation.



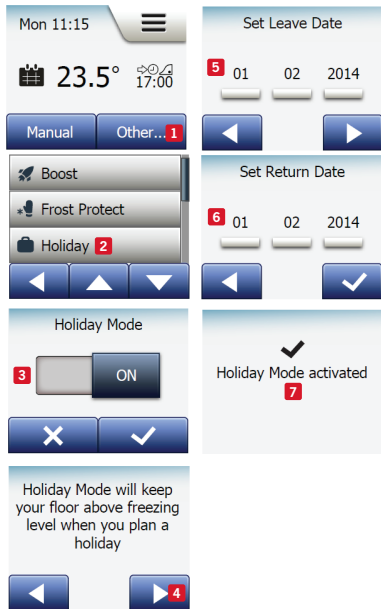

Holiday mode allows you to set the heating of your home to a minimum while you are away on holiday, thus saving energy and money. You must set the date you leave to go on holiday and the date you return. The thermostat will ensure that your floor is kept above freezing point and that your home is warm upon your return. This is accomplished in just a few steps:

1. From the Scheduled Operation home screen, tap the “Other” button to access the alternative operating modes.
2. Tap the “Holiday” button.
3. Tap the “OFF/ON” button to “ON” and confirm with the “✓” button.
4. Tap the “Right Arrow” button on the confirmation screen that appears.
5. Set the date on which you are going on holiday. Tap the “Right Arrow” button.
6. Set the date on which you plan to return. Tap the “Right Arrow” button.
7. A confirmation screen will then be displayed briefly before the thermostat automatically enters the Holiday home screen.

During an active holiday period a suitcase is displayed on the screen together with the programmed leaving and return dates. You can cancel an active holiday period and return the thermostat to Scheduled Operation by tapping the “X” button.

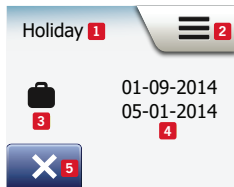

Holiday home screen:

1. Indication of Holiday mode.
2. Tap here to access the menus.
3. Icon indicating the current operating mode (suitcase = Holiday).
4. The date on which the thermostat entered Holiday mode and the date on which the thermostat will return to Scheduled Operation.
5. Tap here to quit Holiday mode and return to Scheduled Operation.
6. If leaving and returning dates have been entered but Holiday mode is not yet active, an alternative Scheduled Operation home screen will be displayed, featuring a suitcase.

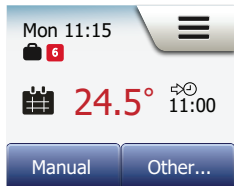

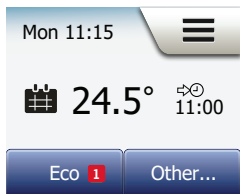

Eco Function reduces the energy spent on unnecessary heating if you leave the room/house during a scheduled heating event. When the Eco Function is enabled, the thermostat enters an energy-saving state, in which the lowest setback temperature in the event schedule is used as the temperature setpoint. At the next scheduled event change, the thermostat returns to normal Scheduled Operation. To be able to use the Eco Function, it has to be enabled under User Settings/Eco Function.

With Eco Function enabled in the User Settings:

1. Tap the “Eco” button on the Scheduled Operation home screen to access the Eco Function.  
The thermostat will then display the Eco Function home screen.

Eco Function home screen:

2. Indication of Eco Function.
3. Tap here to access the menus.
4. Icon indicating the current operating mode (Leaf = Eco Function).
5. Current target/setpoint temperature (if shown in red, heating is being provided).
6. The time at which the thermostat will return to Scheduled Operation.
7. Tap here to return to Scheduled Operation.



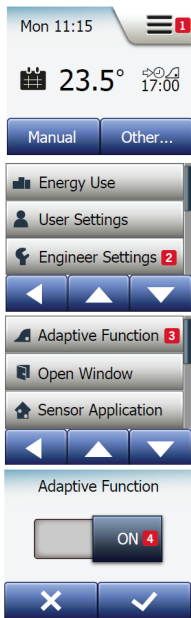

With this feature enabled the thermostat will calculate the time required to heat up and reach the desired temperature set point and will turn on earlier to ensure the floor is at the desired temperature at the start a scheduled heating event.

## **Adaptive function is turned on as default.**

After just a few days, the adaptive function will have automatically calculated how much earlier the heating must be turned on/off to achieve this.

Select “OFF” if you simply want the heating to start at the beginning of an event.

1. Tap the “Menu” button on the home screen.
2. Scroll down and tap the “Engineer Settings” button.
3. Tap the “Adaptive Function” button.
4. Tap the “OFF/ON” button to the setting you prefer and confirm with the “✓” button.
5. The thermostat will automatically return to “Engineer Settings”.



Mon 11:15

23.5° 17:00

Manual Other...

In a week with 2 types of days, week days have 4 heating events, home days have 2 events per day.

The heating schedule allows you to control temperature automatically according to a programmed schedule of your choice. The thermostat comes with a pre-programmed schedule for easy and economic heating control, see Preset Schedule under Factory Settings. The heating schedule can easily be changed in the following way:

Heating Schedule 2

Energy Use

User Settings

Mark Work Days

Mon	Tue	Wed
6		
Thu	Fri	Sat
	Sun	

1. Tap the “Menu” button on the home screen.
2. Then tap the “Heating Schedule” button to access schedule options.
3. Tap the “Week Type” button.

Week Type 3

Event Schedule

Events per Day

Confirm Home Days

Mon	Tue	Wed
✓ Thu	✓ Fri	✓ Sat
	✓ Sun	

Choose between “Work days/home days” and “All days are different”. “Work days/home days” is best if you have fixed working hours.

Your Week Type:

Work days/home days 4

All days are different

Your Week Type:

Work days/home days ✓

All days are different

4. If you chose “Work days/home days”, an information screen about the schedule will be shown. Tap the “Right Arrow” button to proceed.
5. Select the days on which you work. Tap the “Right Arrow” button to proceed.
6. The thermostat will automatically designate the remaining days as home days. Tap the “✓” button to accept.
7. Tap the “Left Arrow” button to return to the “Heating Schedule” menu. Proceed to step 10.

If you chose “All days are different”, each day of the week must be individually programmed, giving you complete control of every single event.

When the information screen appears, press the “✓” to confirm.

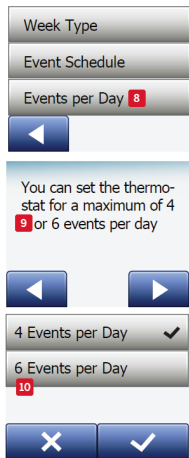

An event is a scheduled time of day when the thermostat automatically changes the temperature setting.

You can choose between a four or six event schedule.

Choose the setting that best fits your daily rhythm.

With a four event schedule, you can set four different events during work days and two different events during home days.

- Perfect if your day is as follows: You get up in the morning, you go to work, you return home and you go to sleep.

With a six event schedule, you can set six different events during work days and two different events during home days.

- Perfect if your day is as follows: You get up in the morning, you go to work, you return home for lunch, you go back to work, you return home and finally you go to sleep.

8. Tap the “Events per Day” button.

9. On the confirmation screen tap the “Right Arrow” button.

10. Tap the button with the number of events per day you wish to use. Confirm with “✓”.

Week Type

Event Schedule **11**

Events per Day

◀

Work Day: Wake Up

24.5° **12** 08:00

◀ ▶

Work Day: Leave Home

24.5° 09:00 **13**

◀ **14** ▶ **14**

**15** ✓ Done

You can now setup your personalised heating schedule.

11. Tap the “Event Schedule” button to set up the target/setpoint temperature and start time for each event.
12. Tap the temperature if you want to change it, then tap the “Up Arrow” or “Down Arrow” button to set the required temperature.
13. Tap the time if you want to change it, then tap the “Up Arrow” or “Down Arrow” button to set the time in increments of 15 minutes. Confirm with “✓”.
14. Tap the “Left Arrow” or “Right Arrow” button to toggle through the various events.
15. Once you have completed setting all the events, tap the “Right Arrow” button to view a confirmation screen and return to the Heating Schedule menu.
16. Tap the back arrow to return to the menu.

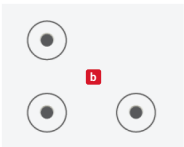
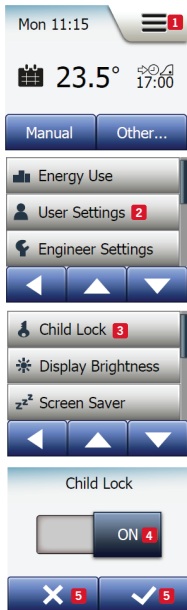

The child lock prevents children and others from tampering with the thermostat and changing any of its settings.

1. Tap the “Menu” button on the home screen.
2. Then tap the “User Settings” button to access the various user settings.
3. Tap the “Child lock” button.
4. Tap the “OFF/ON” button to the setting you prefer.
5. Confirm your choice with “✓” or discard it with “X”.
6. The thermostat will automatically return to “User Settings”.

The child lock is activated together with the screen saver if the thermostat has not been operated for about 3 minutes. Before you can operate the thermostat again, you must unlock the child lock in the following way.

From the idle home screen:

- a) Tap the screen to activate it.  
Three circles containing dots will be displayed on the screen.
- b) Draw an “L” on the screen in a single stroke without lifting your finger from the screen. Start by touching the dot in the circle in the upper left corner, then slide your finger downwards to the dot in the circle in the lower left corner and continue sliding your finger to the dot in the circle in the lower right corner, forming an “L”. If done correctly, the home screen will appear.

Please note that the child lock will be reactivated when the thermostat returns to screen saver mode – unless it is deactivated in the menu: User Settings/Child Lock.

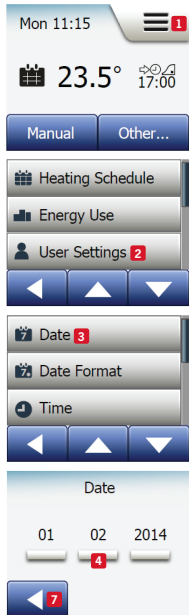

This setting allows you to change the date, which is sometimes shown on the home screen and is used for functions such as “Holiday” mode and “Daylight Saving Time”.

1. Tap the “Menu” button on the home screen.
2. Then tap the “User Settings” button to access the various user settings.
3. Scroll down and tap the “Date” button.
4. Tap the parameter you want to change.
5. Tap the “Up Arrow” or “Down Arrow” button to set the day, month and year.
6. Confirm each setting with “✓”.
7. Tap the “Left Arrow” button to return to “User Settings”.

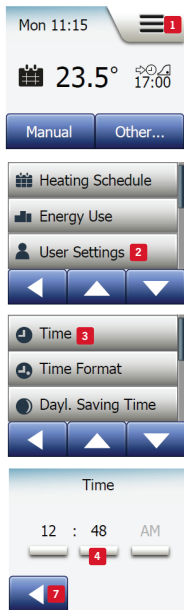

This option allows you to change the time, which is used by the thermostat to control heating schedule events during Scheduled Operation.

1. Tap the “Menu” button on the home screen.
2. Then tap the “User Settings” button to access the various user settings.
3. Scroll down and tap the “Time” button.
4. Tap the parameter you want to change.
5. Tap the “Up Arrow” or “Down Arrow” button to set the hours and minutes.
6. Confirm each setting with “✓”.
7. Tap the “Left Arrow” button to return to “User Settings”.

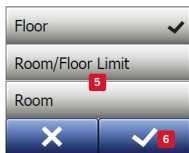
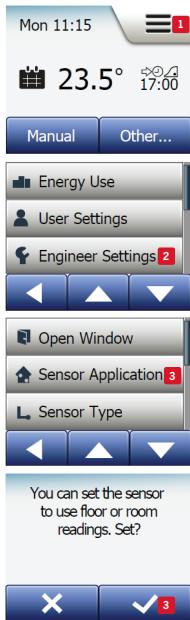

This option allows you to choose which sensor is used to control the heating system.

- Floor (default): With this setting, the floor sensor controls the heating system.
- Room/Floor Limit (advanced): With this setting, the room sensor controls the heating system subject to maximum and minimum limits for floor temperature. The maximum temperature limit protects wooden floors from excessive heat. The minimum temperature limit prevents the floor from becoming uncomfortably cold when heating is not needed, e.g. in a bathroom. Note that this function will increase energy consumption. Floor Limit temperatures are set in the “Temperature Scale” menu.
- Room: With this setting, the room sensor inside the thermostat controls the heating system.

Maximum temperature depends on floor type and temperature scale.

1. Tap the “Menu” button on the home screen.
2. Then tap the “Engineer Settings” button.
3. Tap the “Sensor Application” button.
4. Confirm that you want to set the Sensor Application.
5. Then tap the application you want to use.
6. Confirm your choice with “✓” or discard it with “X”.
7. The thermostat will automatically return to “Engineer Settings”.

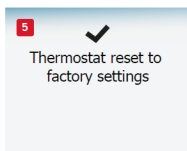
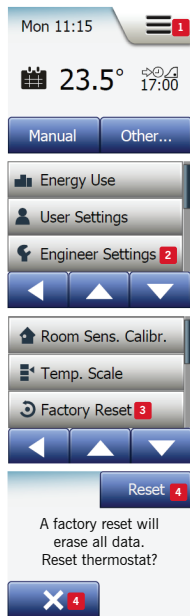

This option allows you to restore the thermostat to factory settings.

**Note! This action cannot be undone, and all your personal settings will be lost.**

1. Tap the “Menu” button on the home screen.
2. Scroll down and tap the “Engineer Settings” button.
3. Tap the “Factory Reset” button.
4. Tap “X” if you want to maintain your settings and return to “Engineer Settings”.  
Tap “Reset” if you want to restore the factory settings.
5. The thermostat will then be reset and the “Startup Wizard” will appear on the screen.



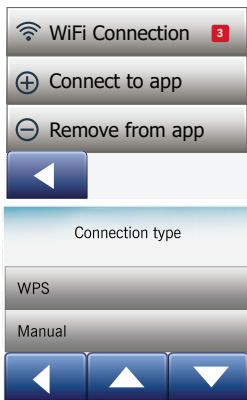

You can set up a Wi-Fi connection in the following way:

1. Tap the “Menu” button on the home screen.
2. Then tap the “App Control” button to access the app setup options.
3. Tap the “Wi-Fi Connection” button to set up the Wi-Fi connection.

Note that if a Wi-Fi configuration is already made, the “Status” screen will be displayed showing the current status of the Wi-Fi connection. In this case, tap the “Right Arrow” button to proceed, or the “Left Arrow” button to return to the main menu.

4. Choose the desired connection type on the “Connection type” screen:
  - Tap “WPS” for automatic setup. Proceed to steps 5 to 6.
  - Tap “Manual” for manual setup. Proceed to steps 7 to 10.

Automatic setup requires that you can activate WPS on the router. For details about the location of the WPS button on your router, please check your router manual.

5. Go to your Wi-Fi router and activate WPS.
6. On your thermostat, tap the “Right Arrow” button to start connecting the thermostat.

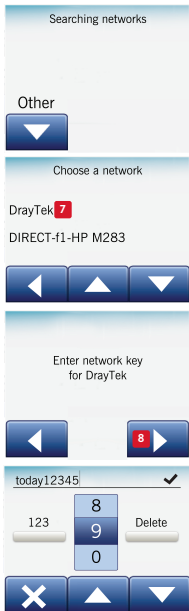

### Manual connection:

The “Searching networks” screen is displayed while the thermostat is searching for available networks. The detected networks are then displayed in a list.

#### 7. Tap the name of the desired network on the list.

If you cannot see the name of your network on the list, you have to enter the network name manually in the following way:

- Tap “Other” at the bottom of the list of networks.
- You are now asked to enter the network name (SSID). Tap the “Right Arrow” button to proceed.
- Enter the network name (SSID) for your wireless network at the top of the screen.
- Confirm the network name with “✓”

See tips on using the keyboard on the following page.

#### 8. You are now asked to enter the network key (password).

Tap the “Right Arrow” button to proceed.

#### 9. Enter the network key (password) for your wireless network at the top of the screen.

Tips on using the keyboard:

- Tap the “Character set” button to the left to choose between different character sets, e.g. lowercase letters, uppercase letters, numbers and special characters.
- Tap the “Up Arrow” and “Down Arrow” buttons to scroll up and down in the selected character set.
- Tap the highlighted character to enter it at the top.
- Tap the “Delete” button to the right to delete the last character.  
If the key is too long to be displayed in the text field, you can tap the text to see the entire text. Tap it again to return to the keyboard.

10. Confirm the network key with “✓” to start connecting the thermostat. The thermostat will now attempt to connect to your wireless network. Please be patient, since this may take a while (several minutes).

- If the connection is successful, a confirmation screen will be displayed briefly. After that the “Status” screen will be displayed showing the current status of the Wi-Fi connection. Tap the “Left Arrow” button to return to the menu.
- If the connection fails, the thermostat will tell you so. In this case, check troubleshooting, and then tap the “X” button to return to step 4 and try again.

If problems persist, or if anything unexpected happens during setup of the Wi-Fi connection, please consult the “Troubleshooting” section in the detailed manual.

You can disconnect a Wi-Fi connection in the following way:

1. Tap the “Menu” button on the home screen.
2. Then tap the “App Control” button to access the app setup options.
3. Tap the “Wi-Fi Connection” button to show the “Status” screen which displays the status of the current Wi-Fi connection.
4. Tap the “Right Arrow” button to proceed to the “Connection type” screen.
5. Tap the down arrow and tap "Disconnect" to remove the current Wi-Fi connection.
6. Confirm with “✓”. You will now return to the App Control menu.
7. A confirmation screen will be displayed briefly.

**Note if you tap the “X” button you will return to the “Connection type” menu.**

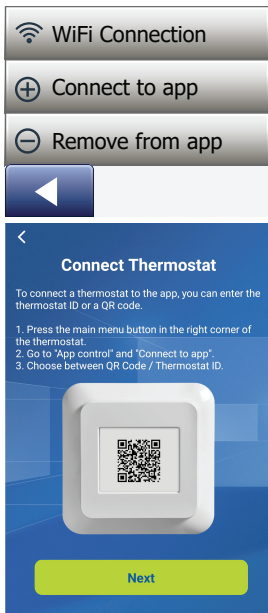

Install the OJ Microline® SWATT app on your smart device.

1. When you have successfully set up a Wi-Fi connection on your thermostat, you can connect it to OJ Microline® SWATT app in the following way:
2. Tap the “Menu” button on the home screen.
3. Then tap the “App Control” button to access the app setup options.
4. Tap the “Connect to App” button to connect to your app.
5. Choose how to connect to your app:
  - Tap “QR Code” to display a QR code that you can scan with your mobile phone.
  - Tap “Thermostat ID” to display the thermostat ID that you can enter in your app.

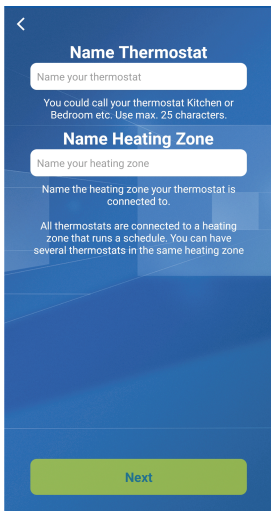

You can now name your thermostat and heating zone.

Your thermostat name helps you identify the exact thermostat such as kitchen.

The zone allows you to place the thermostat in a zone and then add additional thermostats to that zone such as living zone which includes thermostats in the hallway, kitchen and living room.

Wait until the confirmation screen appears on the Thermostat before confirming on both the thermostat and the app. This can take up to a minute.

This completes your wireless connection.

## Adding additional Thermostats

You can add additional Thermostats immediately after adding your first Thermostat by tapping the add more thermostats button at the bottom of the screen.

Alternatively you can add additional thermostats at any time by entering the menu located in the top right hand corner, select manage zones and select to either add a new zone E.G. a family room with multiple thermostats or add a new thermostat to an existing zone.

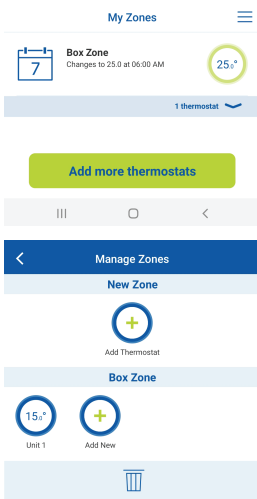

## Controlling your thermostat

To control the mode of your thermostat, tap the required zone from the home screen of your app.

You can then adjust all of the thermostats on that zone or you can select each thermostat individually.

This will allow you to select between manual mode, boost mode, holiday mode and eco mode or return to your heating schedule.

1. To operate in manual mode press and hold the green circle on the dial and slide this to achieve your desired temperature.
2. To operate in boost, comfort or eco modes press the icon at the bottom of the app screen.

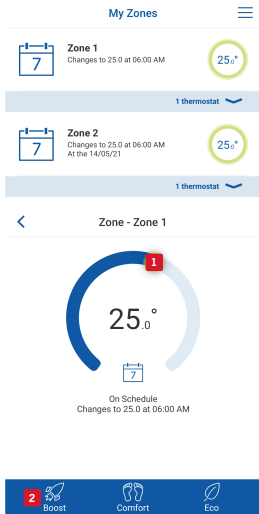



## Setting up your schedule

To set your heating schedule select the menu button in the top right-hand corner and select set up schedule.

3. If you have multiple zone, the various zones will be displayed; select your desired zone.
4. Depending on your daily settings you will have either 4 or 6 zones showing each day. You can select the day that you wish to set your schedule for along the top of the screen.
5. The heating schedule can then be copied to your desired days through using the copy schedule button located at the bottom of the screen.

Set Up Schedule

Zone 1 **3**

Zone 2

Select one of the zones to set up its heating schedule.

Set Up Schedule OK

M T W T **F** S S

Zone 1

Set the start time and temperature for Friday

1. Event	Start time	Temperature
<input type="radio"/>	06:00 AM	25.0°C
<input type="radio"/>	09:00 AM	20.0°C
<input type="radio"/>	12:00 PM	25.0°C
<input type="radio"/> <b>4</b>	01:00 PM	12.0°C
<input type="radio"/>	05:00 PM	25.0°C
<input type="radio"/>	11:00 PM	20.0°C

Set heating schedule based on "all days are different" known from the thermostat, with up to 6 events per day.

**5** Copy Schedule

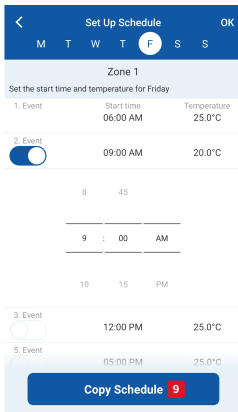
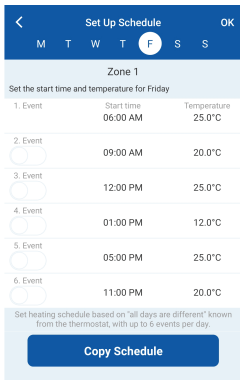

## Setting up your schedule continued

- When setting your schedule begin with event 1 and tap the start time to adjust this. Select your desired on time.
- Select the temperature to set your desired temperature.
- Move on to set event 2, this would normally be considered the off time. You can turn this event on and off using the slide button located directly below the event name on the left hand side. This is turning that entire switching period either on or off not just turning on an off temperature.

Follow the above process to set all the desired times and temperatures for the various events.

- This can then be copied to the various days of the week using the copy schedule button located at the bottom of the screen.
- To save your schedule select OK located in the top right hand corner of the screen.

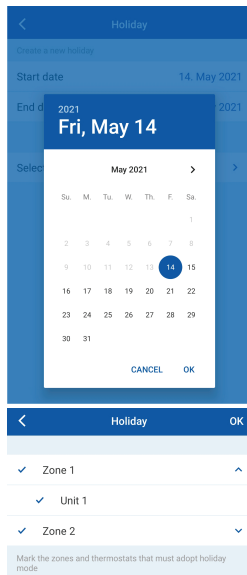

## Setting Holiday Mode

To enter holiday mode select the menu button in the top right hand corner and select the holiday field.

Tap the start date to select your holiday start date and press OK to confirm.

Follow this same process to set the holiday end date.

Tap the select zones button to set the desired zones that you wish to be on holiday mode.

Tap OK to save.

Unit 1	
Open window	Enabled
Adaptive function	Enabled
Sensor application	Room
Error	No error
Software version	1013W212
Serial number	458716
Customer ID	99
Time Zone	UTC+1

## Thermostat Information

You can view a range of your thermostat settings on the app in the Thermostat Information tab. Select the menu in the top right hand corner, select your zone and select Thermostat Information.

This will display information regarding your thermostat. Open Window, Adaptive function and sensor settings all need to be adjusted via the thermostat settings.

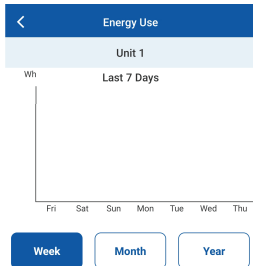

## Energy Usage

You can also view a readout of your energy usage by the thermostat. Select the menu button in the top right hand corner and select energy use. Adjusting your energy usage information can be done on the thermostat. Refer to page 34.

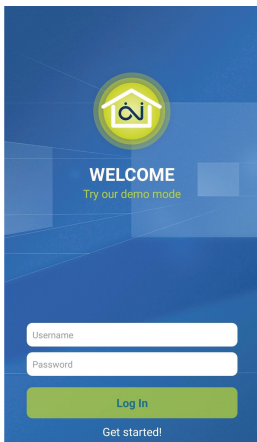

### Adding multiple users to the thermostat

Each individual thermostat can only be connected to one account at any given time.

If multiple people want to be able to control the same thermostats i.e. Multiple family members controlling the same thermostats, they will need to log in under the same account that controls the thermostats.

Your account information can be found under the My Profile tab in the menu section on the app.

### Error messages:

**If a fault or error occurs, the thermostat will display one of the following error messages:**

E0: Internal failure. The thermostat is defective. Contact your heating engineer.  
The thermostat must be replaced.

E1: Internal sensor defective or short-circuited. Contact your heating engineer.  
The thermostat must be replaced.

E2: Check that a floor sensor has been installed and try switching the unit to ambient sensor.

E5: Internal overheating. Contact your heating engineer in order to have the installation inspected.

**Three circles containing dots are displayed on the screen; the thermostat cannot be operated.**

The thermostat is in “Child Lock” mode. To unlock connect the dots in an L shape pattern and refer to page 28 for how to disable.

Internal sensor fault  
(E1)

External wired floor  
sensor fault  
(E2)

Internal overheating.  
Heating is shut off  
(E5)



For further trouble shooting information please refer to the detailed product instructions at [www.thermogroup.com.au/5235W\\_Guide](http://www.thermogroup.com.au/5235W_Guide)

## WIRING DIAGRAM

1. 230/240V AC Supply Neutral
2. 230/240V AC Supply Live
3. UFH Live (Load L)
4. UFH Neutral (Load N)
- X. Do not connect
5. Sensor connections (no polarity)
6. Sensor connection (no polarity)

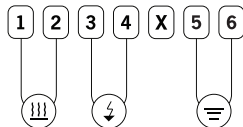

## BOX CONTENTS

- |                        |                       |
|------------------------|-----------------------|
| 1 x 5235W Thermostat   | 1 x 3m Sensor probe   |
| 1 x Mounting Plate     | 1 x 2m Sensor Conduit |
| 1 x Fixing Bracket     | 2 x Fixing Screws     |
| 1 x Installation Guide |                       |

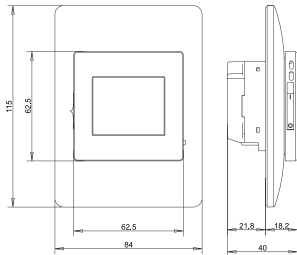

## TECHNICAL DATA

Supply voltage	230/240V 50/60Hz
Maximum load	16A
Temperature range	5 ~ 40°C
Compatible sensors	6.8kΩ, 10kΩ, 12kΩ, 33kΩ, 47kΩ (@25°C)
Accuracy	±0.5°C
Warranty	3 years
IP rating	IP21
Width	84mm
Height	115mm
Depth	40mm (22mm in wall)
Wi-Fi	IEEE 802.11 b/g/n - 2.4GHz
Display	176x220 pixels TFT - resistive touch
Backup Storage	5 Years

Thermogroup

PO Box 822  
Leeton NSW 2705  
AUSTRALIA

**For the detailed instruction version for the 5235W  
please refer to [www.thermogroup.com.au/5235W\\_Guide](http://www.thermogroup.com.au/5235W_Guide)**

**Phone: 1300 368 631  
Technical Line: 1300 989 464**

**[www.thermogroup.com.au](http://www.thermogroup.com.au)  
[sales@thermogroup.com.au](mailto:sales@thermogroup.com.au)**



**Watch the video guide on our website**

[www.thermogroup.com.au](http://www.thermogroup.com.au)